



SAMOSTATN? STOJÍCÍ VILA 4 LOŽNICE

📍 Benahavís

REF# R5317465 – 1.150.000€

IBI

301 €/YEAR

Garbage

18 €/YEAR

Community

432 €/YEAR



4

Ložnice



4

Koupelny



235 m²

Built



808 m²

Plot



121 m²

Terrace

Charming Cottage-Style Villa in the Hills of Benahavís – Excellent Value

Full of character and warmth, this charming cottage-style villa is located in a well-established urbanisation in the peaceful hills of Benahavís. Surrounded by nature and offering a tranquil atmosphere, the property

VILLA ONE Luxury Homes **T** | +34 687 83 44 03 **E** | info@villaone.es **W** | villaone.es
D | Avda. Ricardo Soriano, 72, Edif. Golden B, 1ª Planta, (29601) Marbella, Málaga, España.

enjoys a quiet setting while still being just a short stroll from a small commercial centre with daily amenities, restaurants, and a popular local bar.

The villa is predominantly built on one level, with a few gentle steps leading to certain rooms, adding charm and character to the home. The four bedrooms are distributed across different wings of the house, offering privacy and flexibility for family members or guests. This layout also makes the property ideal as a boutique B&B or a multi-generational holiday home.

Inside, the home features a cosy living room with fireplace, as well as a recently refurbished kitchen and bathrooms. Two of the bathrooms benefit from underfloor heating, adding extra comfort during the cooler months.

Outdoor living is equally appealing, with several inviting spaces designed for relaxation and entertaining. A covered terrace lounge provides the perfect spot to unwind, while a separate covered BBQ and outdoor dining area is ideal for enjoying meals with family and friends. The garden also features a private swimming pool, creating a wonderful setting to enjoy the Mediterranean climate.

Additional features include carport parking for two vehicles and a peaceful environment that combines privacy with everyday convenience.

Offering excellent price-to-value, this delightful villa represents a wonderful opportunity to enjoy the authentic charm of Benahavís while remaining within easy reach of Marbella, the coast, and nearby golf courses.





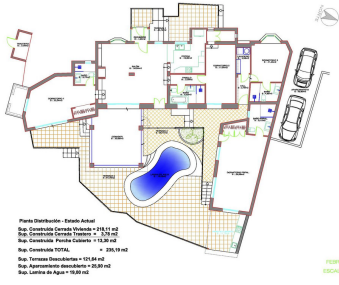

Planta Distribución - Estado Actual
Sup. Construcción Constr. Terminada = 192,13 m²
Sup. Construcción Constr. Pendiente = 3,75 m²
Sup. Construcción Pendiente Constrida = 13,28 m²
Sup. Construcción TOTAL = 209,16 m²
Sup. Terreno Distribuido = 124 m²
Sup. Aparcamiento construido = 28,89 m²
Sup. Constr. en Arque = 18,83 m²

REFERENCIAS
ESCALA = 1:100